

GCL WITH LONG BARREL COPPER TUBE TERMINALS **GCL铜管端子**

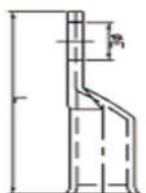
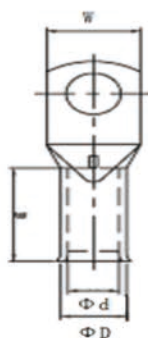

PART NO 2015-2018	ITEM NO	DIMENSIONS					
		ΦE	ΦD	Φd	W	B	L
LY0003-2001	GCL1.5-3	3.2	3.7	1.8	8.0	11.0	21.0
LY0003-2002	GCL1.5-4	4.3	3.7	1.8	8.0	11.0	22.0
LY0003-2003	GCL1.5-5	5.3	3.7	1.8	10.0	12.0	24.0
LY0003-2004	GCL1.5-6	6.5	3.7	1.8	10.0	12.0	25.0
LY0003-2005	GCL2.5-3	3.2	3.9	2.3	8.0	12.0	22.0
LY0003-2006	GCL2.5-4	4.3	3.9	2.3	8.0	12.0	23.0
LY0003-2007	GCL2.5-5	5.3	3.9	2.3	10.0	12.0	25.0
LY0003-2008	GCL2.5-6	6.5	3.9	2.3	10.0	12.0	25.0
LY0003-2009	GCL2.5-8	8.3	4.3	2.3	12.5	12.0	27.5
LY0003-2010	GCL4-4	4.3	4.7	3.0	10.0	13.0	26.0
LY0003-2011	GCL4-5	5.3	4.7	3.0	10.0	13.0	27.0
LY0003-2012	GCL4-6	6.5	4.7	3.0	10.0	13.0	28.0
LY0003-2013	GCL4-8	8.3	4.7	3.0	12.5	13.0	29.0
LY0003-2014	GCL6-4	4.3	5.9	4.0	10.0	18.5	33.6
LY0003-2015	GCL6-5	5.3	5.9	4.0	10.0	18.5	33.6
LY0003-2016	GCL6-6	6.5	5.9	4.0	11.0	18.5	33.6
LY0003-2017	GCL6-8	8.3	5.9	4.0	12.5	18.5	36.3
LY0003-2018	GCL6-10	10.3	6.2	4.0	15.0	18.5	37.3
LY0003-2019	GCL10-5	5.3	6.6	4.5	11.0	22.0	39.0
LY0003-2020	GCL10-6	6.5	6.6	4.5	11.0	22.0	39.0
LY0003-2021	GCL10-8	8.3	6.6	4.5	12.5	22.0	39.0
LY0003-2022	GCL10-10	10.3	6.9	4.5	16.0	22.0	43.1
LY0003-2023	GCL10-12	12.7	6.9	4.5	18.0	21.0	43.1
LY0003-2024	GCL16-5	5.3	7.5	5.5	11.0	23.0	39.7
LY0003-2025	GCL16-6	6.5	7.5	5.5	11.0	23.0	39.7
LY0003-2026	GCL16-8	8.3	7.5	5.5	12.5	22.0	39.7
LY0003-2027	GCL16-10	10.3	7.5	5.5	16.0	23.0	44.9
LY0003-2028	GCL16-12	12.7	8.1	5.5	18.0	22.0	44.9
LY0003-2029	GCL25-5	5.3	9.1	6.7	13.0	28.0	47.2
LY0003-2030	GCL25-6	6.5	9.1	6.7	13.0	28.0	47.2
LY0003-2031	GCL25-8	8.3	9.1	6.7	13.0	28.0	47.2
LY0003-2032	GCL25-10	10.3	9.1	6.7	16.0	29.0	51.9
LY0003-2033	GCL25-12	12.7	9.1	6.7	18.0	28.0	51.9
LY0003-2034	GCL25-14	14.8	9.1	6.7	20.0	28.0	53.9
LY0003-2035	GCL35-5	5.3	11.0	8.6	16.0	31.0	52.6
LY0003-2036	GCL35-6	6.5	11.0	8.6	16.0	31.0	52.6
LY0003-2037	GCL35-8	8.3	11.0	8.6	16.0	31.0	52.6
LY0003-2038	GCL35-10	10.3	11.0	8.6	16.7	31.0	56.5
LY0003-2039	GCL35-12	12.7	11.0	8.6	18.0	31.0	56.5
LY0003-2040	GCL35-14	14.8	11.0	8.6	20.0	31.0	58.5
LY0003-2041	GCL35-16	16.5	11.0	8.6	23.0	31.0	60.5
LY0003-2042	GCL50-5	5.3	12.4	9.5	18.0	32.0	56.0
LY0003-2043	GCL50-6	6.5	12.4	9.5	18.0	32.0	56.0
LY0003-2044	GCL50-8	8.3	12.4	9.5	18.0	32.0	56.0
LY0003-2045	GCL50-10	10.3	12.4	9.5	18.0	32.0	59.0